



Valves

Handling the world's dry bulk solids®

VORTEX® 2-WAY FLEX TUBE DIVERTER™

The Vortex® Flex Tube Diverter™ is specifically engineered to handle dry bulk solids in vacuum or dilute phase pneumatic conveying systems up to 15 psig (1 barg). The unique design eliminates material cross contamination by a positive seal across the closed port and the elimination of internal ledges and pockets where material can lodge and remain trapped. A smooth unobstructed transition from inlet to outlet shields the wear compensating seals from abrasion. The Flex Tube Diverter™ is designed to eliminate problems, enabling you to meet your objectives by increasing production, while decreasing labour and equipment costs.

Vortex® Flex Tube Diverter™ Features

- Improves Conveying Efficiency
- Smooth, Unobstructed Bore for Unrestricted Flow of Material
- Seals Protected from Abrasion
- Easy Installation and Maintenance



Valve Specifications

Size/Bore Options	50mm to 200mm Diameters, Pipe or Tube
Media	Powder, Pellets, Granulars
Connection Options	Compression Coupling, ANSI, DIN, JIS, Custom Flanges
Media Temperature	Up to 82°C continuous to 121°C intermittent service, Modifications allow up to 121°C continuous to 149°C intermittent service
Media Pressure	-0.1 MPa +0.1 MPa, 1 barg, 15 psig, depending on size
Metal Construction Options	304 or 316L Stainless Steel, Aluminium, and/or Carbon Steel
Seal/Seat Material Options	Nylon, PET, UHMW, Glass Filled Teflon, Rubber, and/or Silicon
Drive/Actuation Options	Double Acting Air Cylinder and Solenoid Operated Air Control Valve, Electric Actuator, or Hand Wheel
Position Confirmation	Magnetic Reed Switch or Proximity Switch
Compliance/Approvals	CE, ATEX, FDA
Industry Use	Plastics, Petrochemicals, Chemicals, Foods, Minerals, Textiles, Agriculture

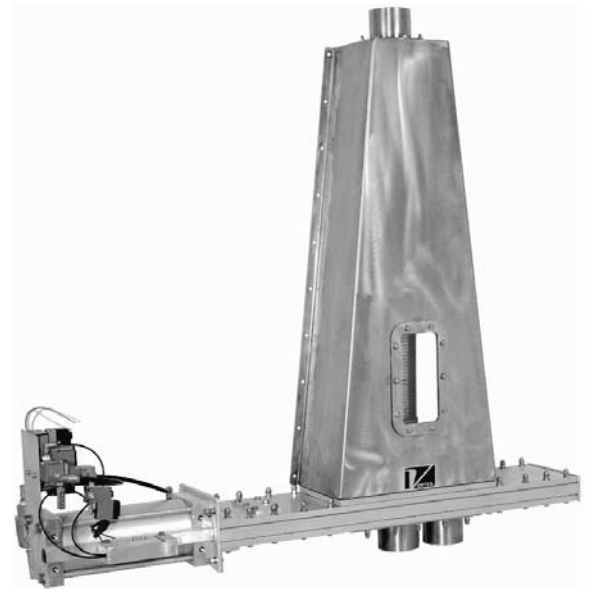

Application Specific Modifications

FS1	304 Stainless Steel directional flex hose is installed for material to run through the valve from one port to two ports.
FS2	304 Stainless Steel directional flex hose is installed for material to run through the valve from two ports to one port.
S	Material contact is 316L stainless steel.
MG	Air cylinder has a magnetic ring which activates a magnetic reed position indicating switch.
HT3	Modifications are made allowing 204°C continuous to 232°C intermittent service.
SM	Slide Blade is electro-polished. Polyethylene Terephthalate (PET) pressure plate seals replace Nylon.
P1/P4	Utilizing Schedule 10 or Schedule 40 Pipe.
OF 45/30	Inlets and outlets are flanged with ANSI, DIN or JIS connections. The outlet opposite the air cylinder is offset at 45 or 30 degrees.



VORTEX® 2-WAY FLEX TUBE DIVERTER™ DIMENSIONAL INFORMATION

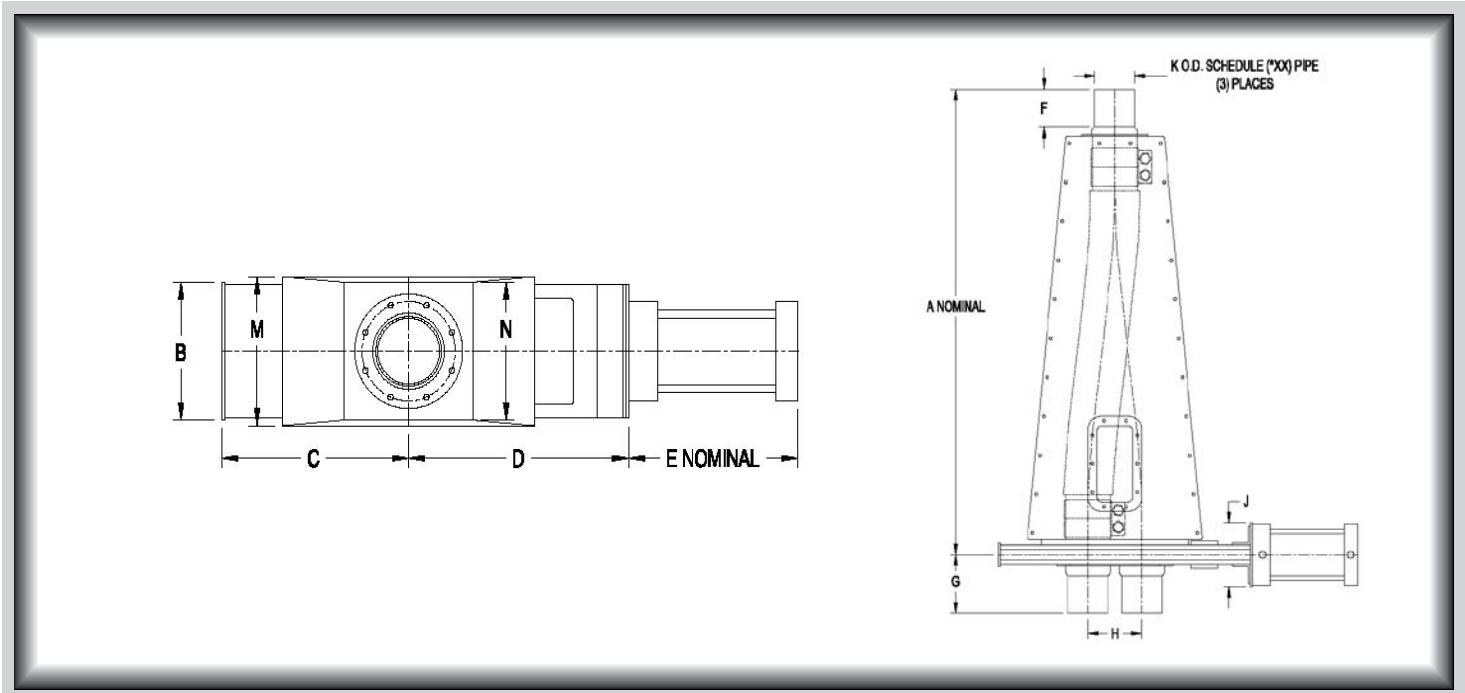

MODEL	TUBE SIZE	A	B	C	D	E	F	G	H	J	K	M	N	WT (kg)
T2-2(XX)Y	51	775	127	149	197	184	76	108	64	121	51	159	127	36
T2.5-2(XX)Y	64	895	165	197	251	203	105	133	89	133	64	203	168	41
T3-2(XX)Y	76	867	165	197	251	203	73	105	89	159	76	203	168	43
T4-2(XX)Y	102	1108	191	270	340	248	79	108	127	140	102	216	181	57
T5-2(XX)Y	127	1213	229	330	391	298	95	130	152	171	127	248	232	66
T6-2(XX)Y	152	1527	264	378	441	324	102	130	178	171	152	298	257	98
T8-2(XX)Y	203	1664	318	546	584	406	98	235	254	194	203	333	333	120

MODEL	PIPE SIZE	A	B	C	D	E	F	G	H	J	K	M	N	WT (kg)
T2-2(XX)Y-P*	51	895	165	197	251	203	76	133	89	159	60	203	168	45
T2.5-2(XX)Y-P*	64	895	165	197	251	203	76	133	89	159	73	203	168	45
T3-2(XX)Y-P*	76	1159	191	270	340	235	102	159	127	140	89	216	181	59
T4-2(XX)Y-P*	102	1245	229	330	391	298	102	159	152	171	114	248	232	68
T5-2(XX)Y-P*	127	1553	264	378	441	324	102	156	178	171	141	298	257	100
T6-2(XX)Y-P*	152	1565	264	378	441	324	102	187	194	171	168	298	257	100
T8-2(XX)Y-P*	203	1759	318	546	584	406	152	241	254	194	219	333	333	123

All dimensions are in mm, Information subject to change without notice.

(XX) Material of construction, aluminum (AL), carbon steel (CS), or stainless steel (SS).

*Select pipe schedule 10 or 40, note flex tube is O.D. hose.